

Torch heads DIX MET 350/352/354, METR 358

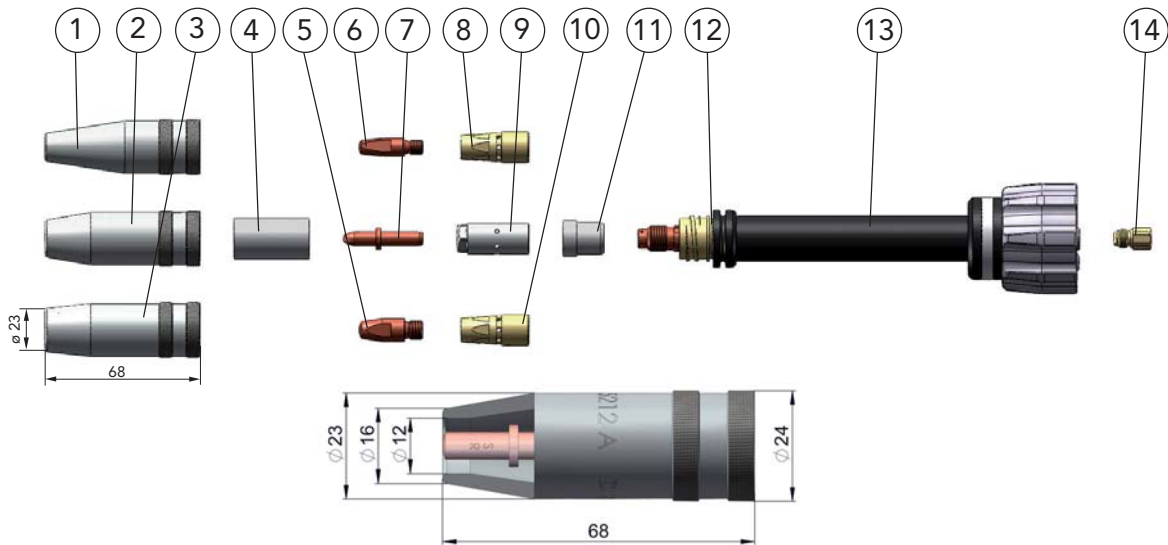

Description	Dimension	Part name	Part number
1 Gas nozzle	ID ø 9 mm	DIX 1-3-5209 A	6390152090
2 Gas nozzle	ID ø 12 mm	DIX 1-3-5212 A	6390152120
3 Gas nozzle	ID ø 15 mm	DIX 1-3-5215 A	6390152150
4 Insulator For pos. 2 and 3		DIX 2-3-520	6390252000
5 Contact tip	M8 x 28 mm	DIX 3-2-__ M8	6290301__
Contact tip	M8 x 28 mm	DIX 3-2-__ M8 CR-ZR	6290331__
6 Contact tip	M6 x 28 mm	DIX 3-2-__	6290300__
Contact tip	M6 x 28 mm	DIX 3-2-__ CR-ZR	6290330__
7 Contact tip	ø 6 x 35 mm	DIX 3-1-__ SR	6190354__
8 Tip adapter	M6	DIX GS 300 M6	629040301
9 Clamp nut		DIX CS 300	6390433000
10 Tip adapter	M8	DIX GS 300 M8	629040302
11 Insulating sleeve		DIX IH 300	6391053000
12 O - ring	(10 pcs.)		639060004
13 Torch neck	0°	DIX 6-3-350 MET	639063350
Torch neck	22°	DIX 6-3-352 MET	639063352
Torch neck	45°	DIX 6-3-354 MET	639063354
Torch neck Swan neck	30°	DIX 6-3-358 METR	639067358
14 Connecting piece		DIX MES 300/500	639061500041
Connecting piece, MEPTZ (without picture)		DIX MEPS 300/500	6390665000
Clamp sleeve (without picture)		DIX SH 270	629270270

__ Enter the required wire diameter, e.g.: 08 = 0.8 mm or 10 = 1.0 mm.

- ▶ Standard equipment for wire diameter 1.0 mm steel with gas nozzle diameter 15 mm, DIX 1-3-5215 A, (contact tip, DIX 3-1-1.0 S, flush, clamp nut DIX CS 300, insulating sleeve DIX IH 300). Use the hook spanner DIX SLAT 4 to fix the torch heads. Variants deviating of the standard fittings on request.

